

## Appendix 12.2: Passing Bay Locations



MULLAGHCLOGHER  
WIND FARM

APPENDIX 12.2

PASSING BAY LOCATIONS

THE LAND & PROPERTY SERVICES INTELLECTUAL PROPERTY IS CROWN COPYRIGHT AND IS REPRODUCED WITH THE PERMISSION OF LAND & PROPERTY SERVICES UNDER DELEGATED AUTHORITY FROM THE CONTROLLER OF HER MAJESTY'S STATIONERY OFFICE, © CROWN COPYRIGHT AND DATABASE RIGHT 2025 LICENCE NO. 242.

KEY:

- PROPOSED DELIVERY ROUTE
- SITE BOUNDARY

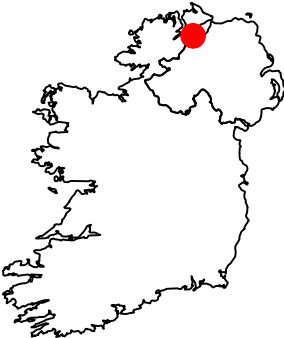

SITE LOCATION - NOT TO SCALE

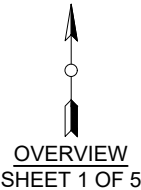

LAYOUT DWG	N/A	T-LAYOUT NO.	N/A
------------	-----	--------------	-----

DRAWING NUMBER	REV
04398-RES-ACC-DR-LO-009	1

SCALE - AS SHOWN @ A3

TRANSPORT & TRAFFIC  
2025

THIS DRAWING IS THE PROPERTY OF RENEWABLE ENERGY SYSTEMS LTD. AND NO REPRODUCTION MAY BE MADE IN WHOLE OR IN PART WITHOUT PERMISSION

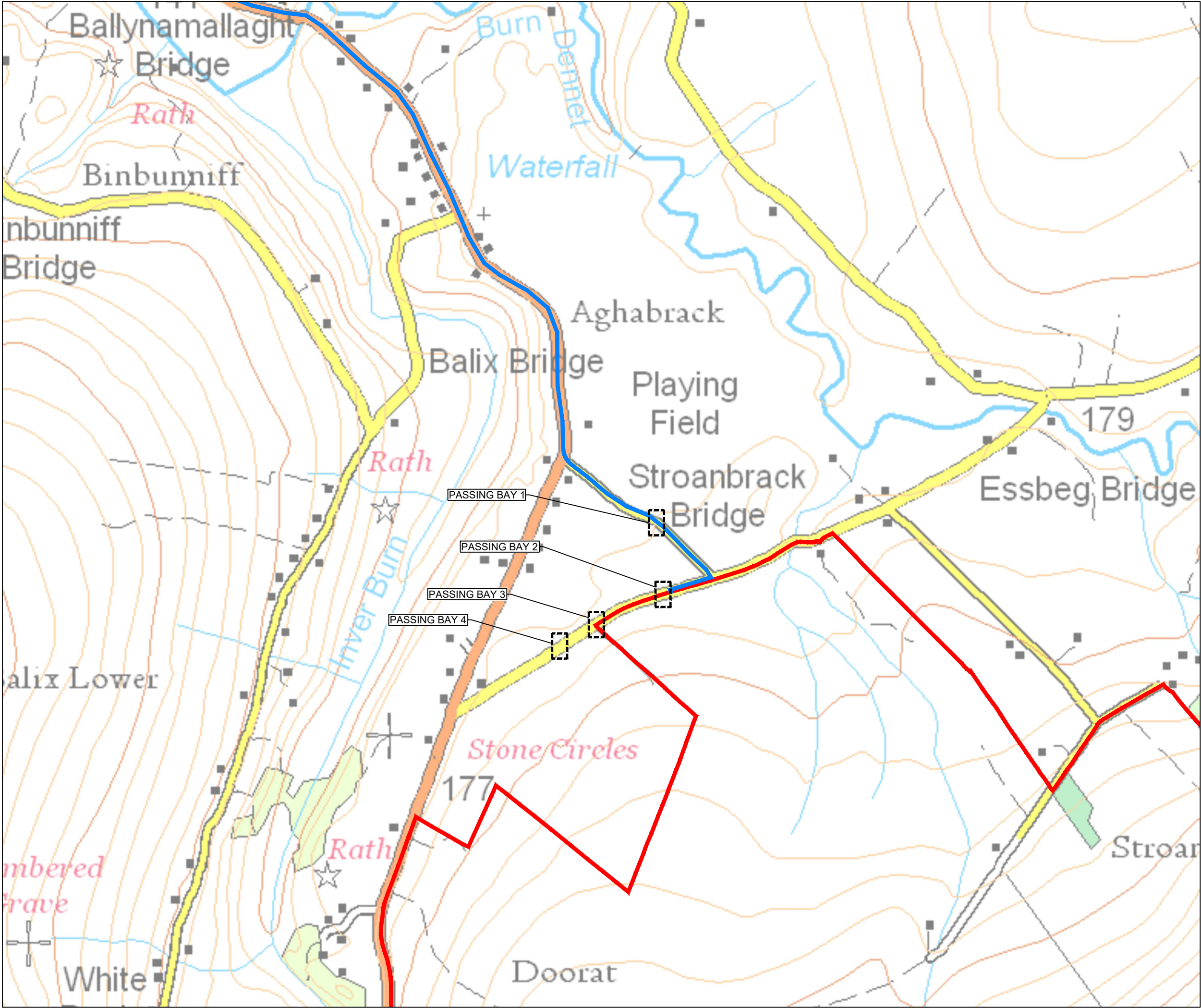



MULLAGHCLOGHER  
WIND FARM

APPENDIX 12.2  
PASSING BAY LOCATIONS

THE LAND & PROPERTY SERVICES INTELLECTUAL PROPERTY IS CROWN COPYRIGHT AND IS REPRODUCED WITH THE PERMISSION OF LAND & PROPERTY SERVICES UNDER DELEGATED AUTHORITY FROM THE CONTROLLER OF HER MAJESTY'S STATIONERY OFFICE, © CROWN COPYRIGHT AND DATABASE RIGHT 2025 LICENCE NO. 242.

KEY:

- EXISTING ROAD/TRACK SURFACE
- PASSING BAY LOCATION

NOTES:

- ALL RELEVANT AUTHORITIES TO BE CONSULTED ON RELOCATION / REMOVAL OF STREET FURNITURE.
- ANY SURFACE WATER WILL BE DIRECTED TO EXISTING DRAINAGE. EXACT METHOD, DESIGN & CONSTRUCTION TO BE CONFIRMED AT DETAIL DESIGN STAGE AND IN AGREEMENT WITH TRANSPORT NI.
- ALL DESIGN IS INDICATIVE AND SUBJECT TO AGREEMENT WITH TRANSPORT NI.

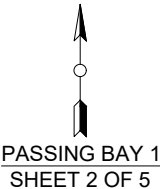

LAYOUT DWG N/A T-LAYOUT NO. N/A

DRAWING NUMBER 04398-RES-ACC-DR-LO-009 REV 1

SCALE - AS SHOWN @ A3

TRANSPORT & TRAFFIC  
2025

THIS DRAWING IS THE PROPERTY OF RENEWABLE ENERGY SYSTEMS LTD. AND NO REPRODUCTION MAY BE MADE IN WHOLE OR IN PART WITHOUT PERMISSION

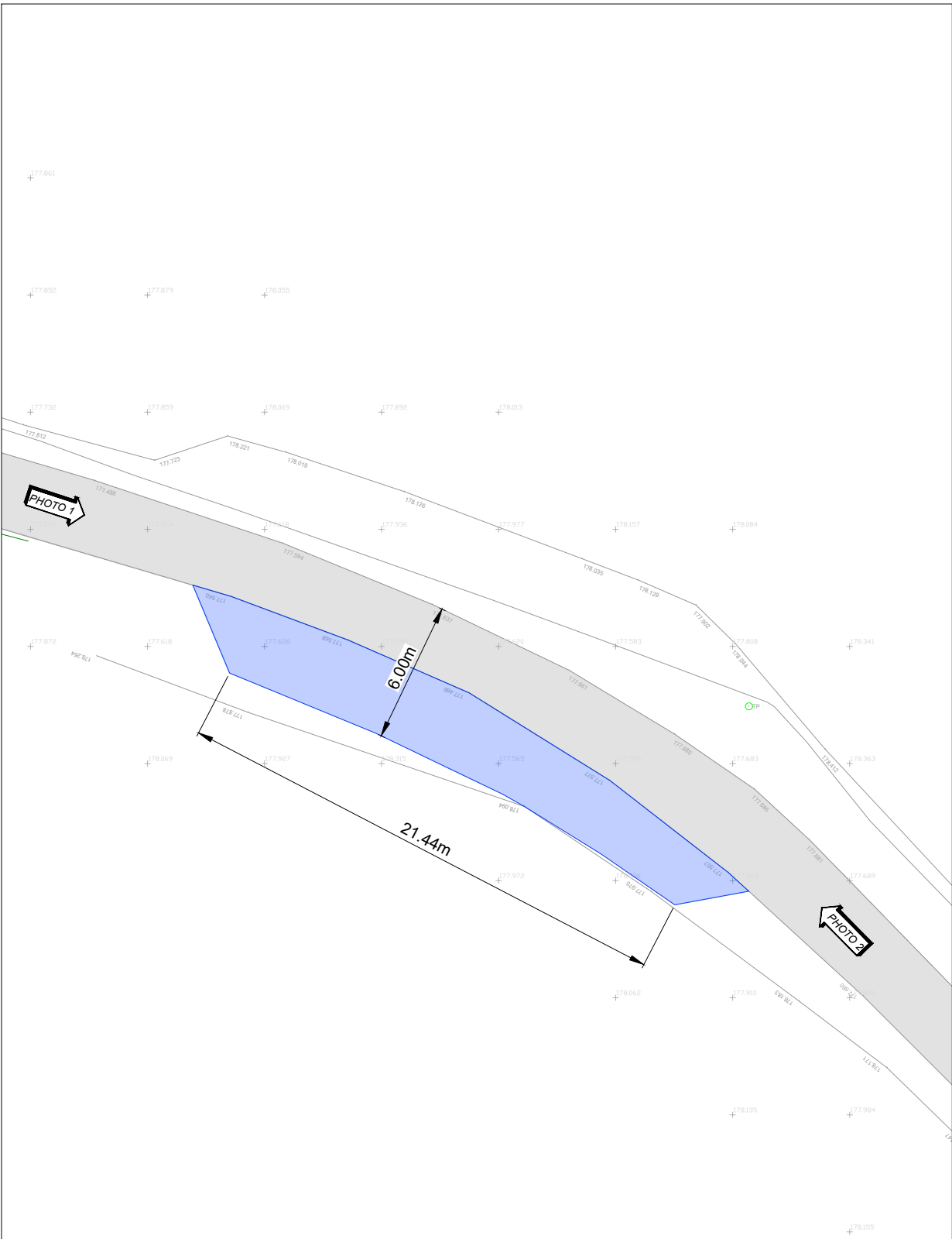

PASSING BAY 1  
E249969, N397491  
SCALE - 1:250

DEPTH OF ROAD CONSTRUCTION IN PASSING BAY TO BE CONFIRMED AT DETAIL DESIGN STAGE. ROAD CONSTRUCTION BUILD-UP & MATERIAL TO COMPLY WITH SERIES 600 OF MCDHW.



EXISTING ROAD MAKE-UP TO BE VERIFIED PRIOR TO DETAILED DESIGN)

TYPICAL PASSING BAY  
SECTION  
SCALE - 1:100



MULLAGHCLOGHER  
WIND FARM

APPENDIX 12.2  
PASSING BAY LOCATIONS

THE LAND & PROPERTY SERVICES INTELLECTUAL PROPERTY IS CROWN COPYRIGHT AND IS REPRODUCED WITH THE PERMISSION OF LAND & PROPERTY SERVICES UNDER DELEGATED AUTHORITY FROM THE CONTROLLER OF HER MAJESTY'S STATIONERY OFFICE, © CROWN COPYRIGHT AND DATABASE RIGHT 2025 LICENCE NO. 242.

- KEY:
- EXISTING ROAD/TRACK SURFACE
  - PASSING BAY LOCATION

- NOTES:
- ALL RELEVANT AUTHORITIES TO BE CONSULTED ON RELOCATION / REMOVAL OF STREET FURNITURE.
  - ANY SURFACE WATER WILL BE DIRECTED TO EXISTING DRAINAGE. EXACT METHOD, DESIGN & CONSTRUCTION TO BE CONFIRMED AT DETAIL DESIGN STAGE AND IN AGREEMENT WITH TRANSPORT NI.
  - ALL DESIGN IS INDICATIVE AND SUBJECT TO AGREEMENT WITH TRANSPORT NI.

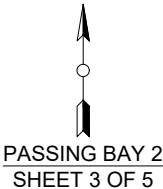

LAYOUT DWG	N/A	T-LAYOUT NO.	N/A
DRAWING NUMBER	04398-RES-ACC-DR-LO-009		REV 1
SCALE - AS SHOWN @ A3			
TRANSPORT & TRAFFIC 2025			
THIS DRAWING IS THE PROPERTY OF RENEWABLE ENERGY SYSTEMS LTD. AND NO REPRODUCTION MAY BE MADE IN WHOLE OR IN PART WITHOUT PERMISSION			

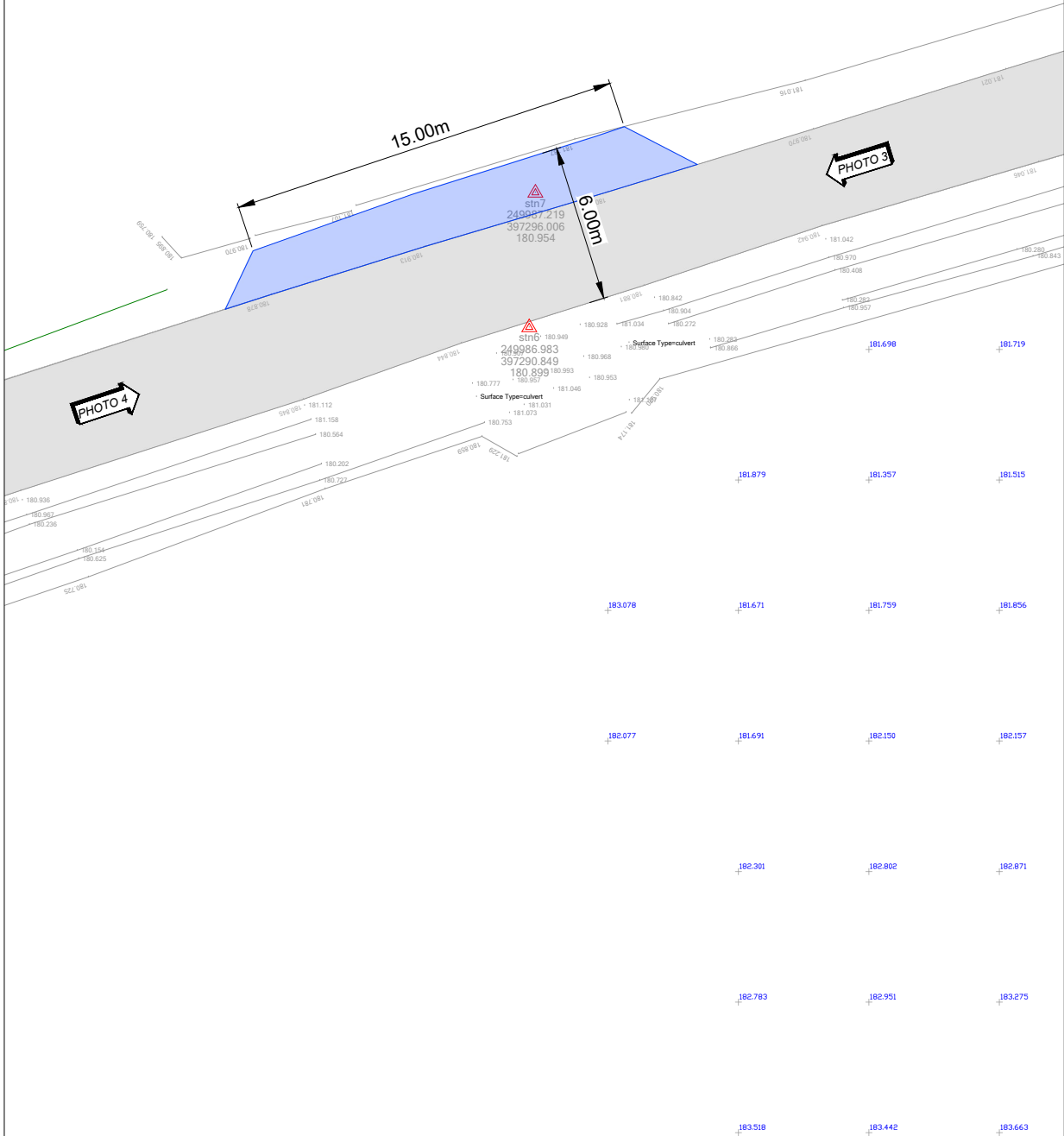

PASSING BAY 2  
E249984, N397295  
SCALE - 1:250



DEPTH OF ROAD CONSTRUCTION IN PASSING BAY TO BE CONFIRMED AT DETAIL DESIGN STAGE. ROAD CONSTRUCTION BUILD-UP & MATERIAL TO COMPLY WITH SERIES 600 OF MCDHW.

EXISTING ROAD MAKE-UP TO BE VERIFIED PRIOR TO DETAILED DESIGN)

TYPICAL PASSING BAY  
SECTION  
SCALE - 1:100



MULLAGHCLOGHER  
WIND FARM

APPENDIX 12.2  
PASSING BAY LOCATIONS

THE LAND & PROPERTY SERVICES INTELLECTUAL PROPERTY IS CROWN COPYRIGHT AND IS REPRODUCED WITH THE PERMISSION OF LAND & PROPERTY SERVICES UNDER DELEGATED AUTHORITY FROM THE CONTROLLER OF HER MAJESTY'S STATIONERY OFFICE, © CROWN COPYRIGHT AND DATABASE RIGHT 2025 LICENCE NO. 242.

- KEY:
- EXISTING ROAD/TRACK SURFACE
  - PASSING BAY LOCATION

- NOTES:
- ALL RELEVANT AUTHORITIES TO BE CONSULTED ON RELOCATION / REMOVAL OF STREET FURNITURE.
  - ANY SURFACE WATER WILL BE DIRECTED TO EXISTING DRAINAGE. EXACT METHOD, DESIGN & CONSTRUCTION TO BE CONFIRMED AT DETAIL DESIGN STAGE AND IN AGREEMENT WITH TRANSPORT NI.
  - ALL DESIGN IS INDICATIVE AND SUBJECT TO AGREEMENT WITH TRANSPORT NI.

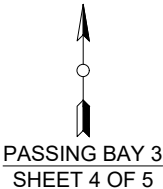

LAYOUT DWG N/A T-LAYOUT NO. N/A

DRAWING NUMBER 04398-RES-ACC-DR-LO-009 REV 1

SCALE - AS SHOWN @ A3

TRANSPORT & TRAFFIC  
2025

THIS DRAWING IS THE PROPERTY OF RENEWABLE ENERGY SYSTEMS LTD. AND NO REPRODUCTION MAY BE MADE IN WHOLE OR IN PART WITHOUT PERMISSION

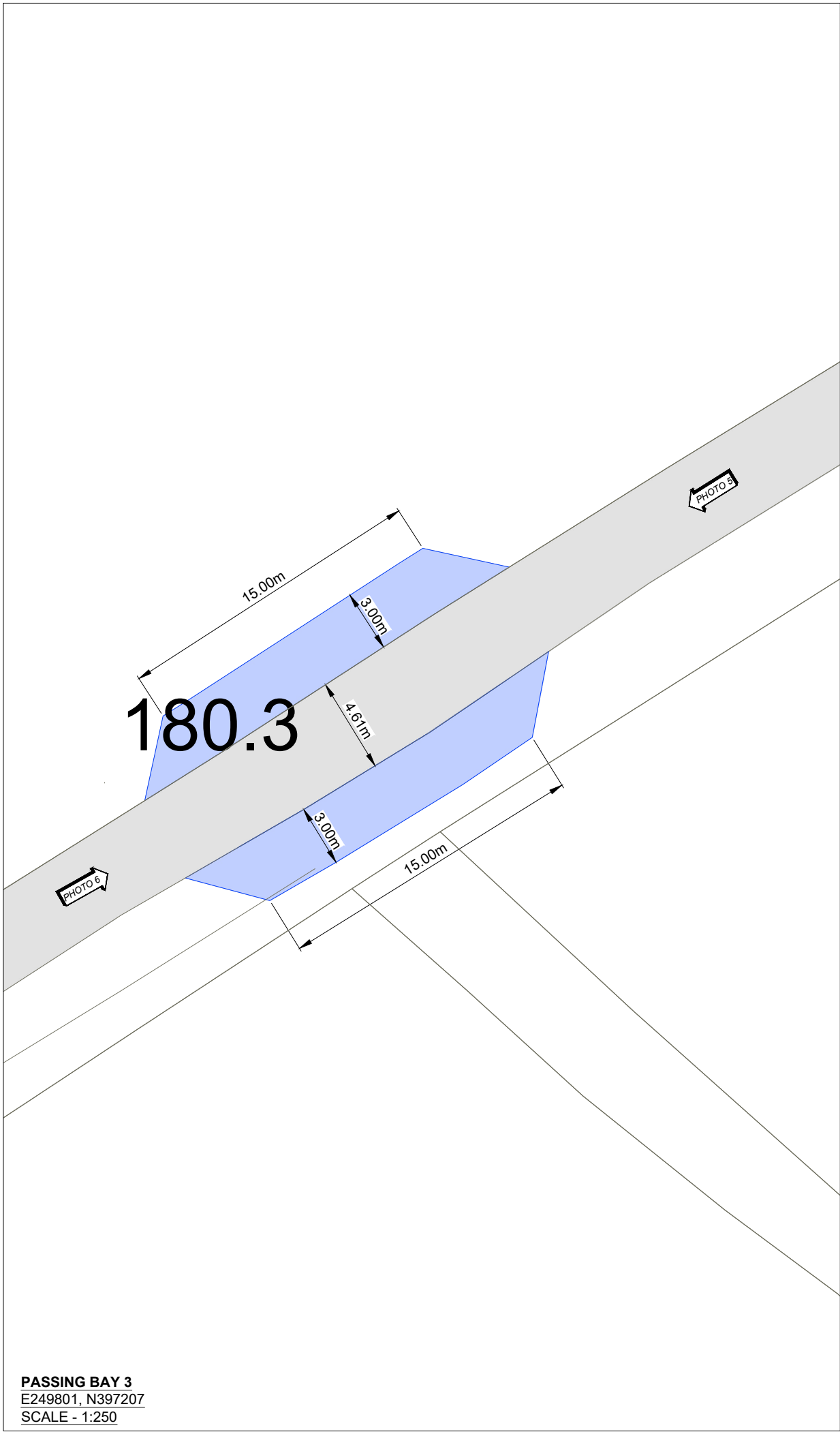

PASSING BAY 3  
E249801, N397207  
SCALE - 1:250

DEPTH OF ROAD CONSTRUCTION IN PASSING BAY TO BE CONFIRMED AT DETAIL DESIGN STAGE.  
ROAD CONSTRUCTION BUILD-UP & MATERIAL TO COMPLY WITH SERIES 600 OF MCDHW.



EXISTING ROAD MAKE-UP TO BE VERIFIED PRIOR TO DETAILED DESIGN

TYPICAL PASSING  
BAY SECTION  
SCALE - 1:100



MULLAGHCLOGHER  
WIND FARM

APPENDIX 12.2  
PASSING BAY LOCATIONS

THE LAND & PROPERTY SERVICES INTELLECTUAL PROPERTY IS CROWN COPYRIGHT AND IS REPRODUCED WITH THE PERMISSION OF LAND & PROPERTY SERVICES UNDER DELEGATED AUTHORITY FROM THE CONTROLLER OF HER MAJESTY'S STATIONERY OFFICE, © CROWN COPYRIGHT AND DATABASE RIGHT 2025 LICENCE NO. 242.

- KEY:
- EXISTING ROAD/TRACK SURFACE
  - PASSING BAY LOCATION

- NOTES:
- ALL RELEVANT AUTHORITIES TO BE CONSULTED ON RELOCATION / REMOVAL OF STREET FURNITURE.
  - ANY SURFACE WATER WILL BE DIRECTED TO EXISTING DRAINAGE. EXACT METHOD, DESIGN & CONSTRUCTION TO BE CONFIRMED AT DETAIL DESIGN STAGE AND IN AGREEMENT WITH TRANSPORT NI.
  - ALL DESIGN IS INDICATIVE AND SUBJECT TO AGREEMENT WITH TRANSPORT NI.

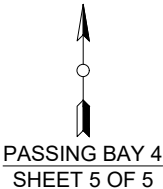

LAYOUT DWG	N/A	T-LAYOUT NO.	N/A
------------	-----	--------------	-----

DRAWING NUMBER	REV
04398-RES-ACC-DR-LO-009	1

SCALE - AS SHOWN @ A3

TRANSPORT & TRAFFIC  
2025

THIS DRAWING IS THE PROPERTY OF RENEWABLE ENERGY SYSTEMS LTD. AND NO REPRODUCTION MAY BE MADE IN WHOLE OR IN PART WITHOUT PERMISSION

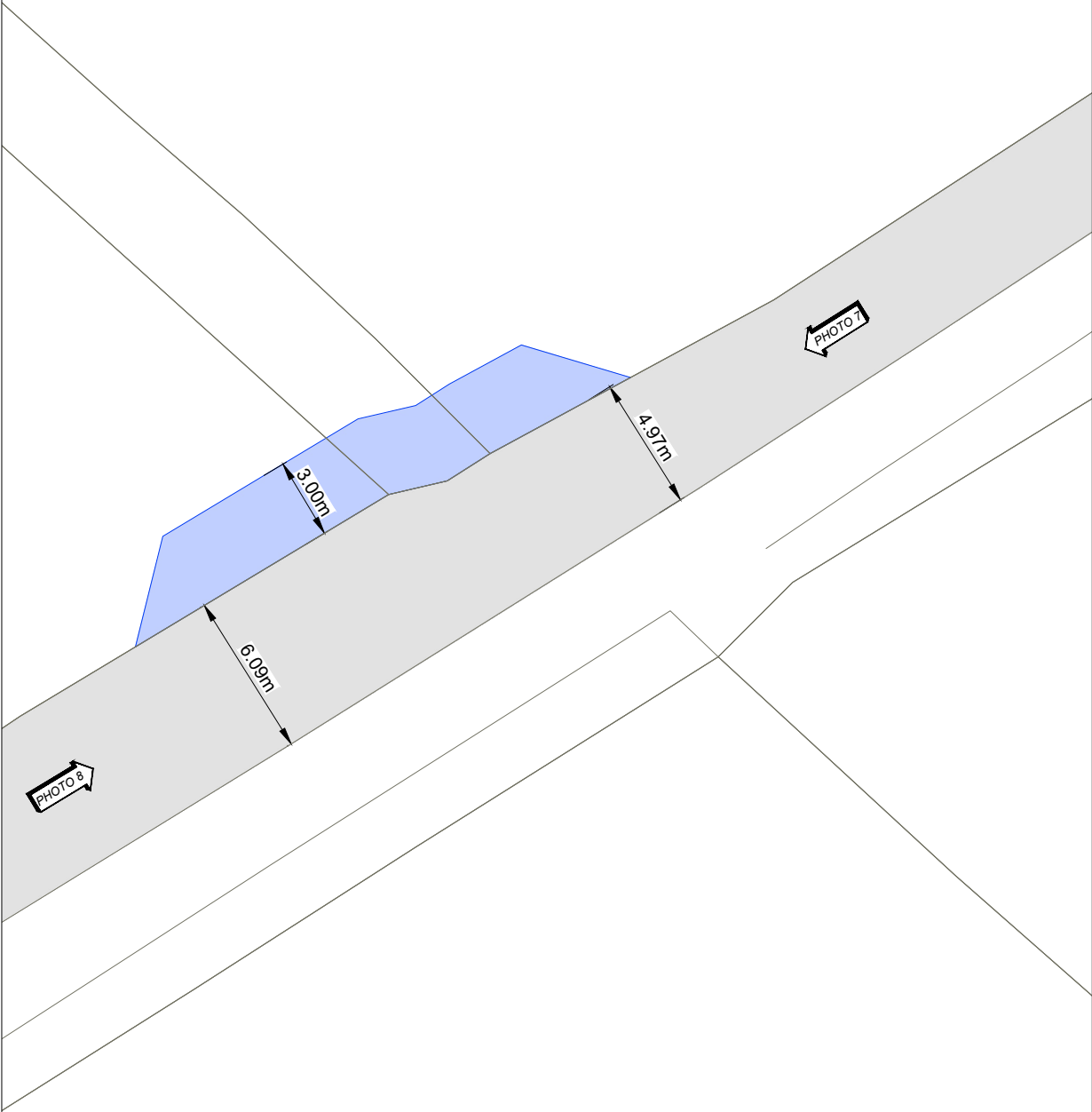

PASSING BAY 4  
E249696, N397146  
SCALE - 1:250



DEPTH OF ROAD CONSTRUCTION IN PASSING BAY TO BE CONFIRMED AT DETAIL DESIGN STAGE.  
ROAD CONSTRUCTION BUILD-UP & MATERIAL TO COMPLY WITH SERIES 600 OF MCDHW.

EXISTING ROAD MAKE-UP TO BE VERIFIED PRIOR TO DETAILED DESIGN)

TYPICAL PASSING BAY  
SECTION  
SCALE - 1:100